

**IMPORTANT: Read all instructions prior to installation!
Keep instructions for future reference!**

Project:	
Date of Purchase	



Included Parts List:

- (24) 18" Light Bar 6W
- (1) 5ft Power Cord
- (11) 120° Connector
- (9) Y Connector
- (20) Cable Tie
- (20) Screw + Anchor
- (2) Wire Connectors

IMPORTANT SAFETY & NOTES WARNING

- Before installing, servicing, or performing routine maintenance upon this equipment, follow these general precautions.
- To reduce the risk of death, personal injury or property damage from fire, electric shock, falling parts, cuts/abrasions, and other hazards read all warnings and instructions included with and on the fixture box and all fixture labels.
- Product should be installed by a certified electrician in accordance with applicable national, state, and local building and electrical codes.
- Failure to properly support the fixture may result in damage or injury, for which the manufacturer does not assume responsibility.
- To prevent wiring damage or abrasion, do not expose wiring to edges of sheet metal or other sharp objects.
- Do not make or alter any open holes in an enclosure of wiring or electrical components during installation.

WARNING

- Turn off electrical power at fuse or circuit breaker box before wiring fixture to the power supply!
- Turn off the power when you perform any maintenance.
- Verify that supply voltage is correct by comparing it with the luminaire label information.

- All wiring connections should be capped with UL approved wire connectors.

CAUTION

- Avoid direct eye exposure to the light source while it is on
- Account for small parts and destroy packing material, as these may pose hazardous to children.
- Risk of burn! Disconnect power and allow fixture to cool before handling.
- Do NOT load more than 360W with one power cord.
- Not suitable for outdoor or wet environments! Indoor, dry location use only.

Recommended Tool List (Not included):

- Screw driver or Power Drill
- Hammer
- Electrical Meter

Electrical Specifications

Power	Input voltage	Frequency	Luminous Efficacy	Color Temperature	Operating Temperature	IP Rating
144W	100-277V	50-60Hz	120	5000K	-13°F ~ 113°F	IP44

Connectors

120° (A)



Y Connector (B)



INSTALLATION INSTRUCTIONS - CONNECTING THE TUBES

It is recommended to layout the light bars and connect all of them all together with the appropriate connectors to form the 5-Hexagon on the ground level before installing. Reference the diagram below for how to lay out the design and what connectors to use.

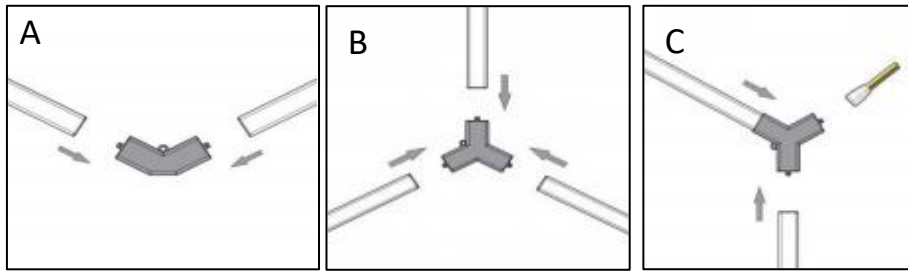
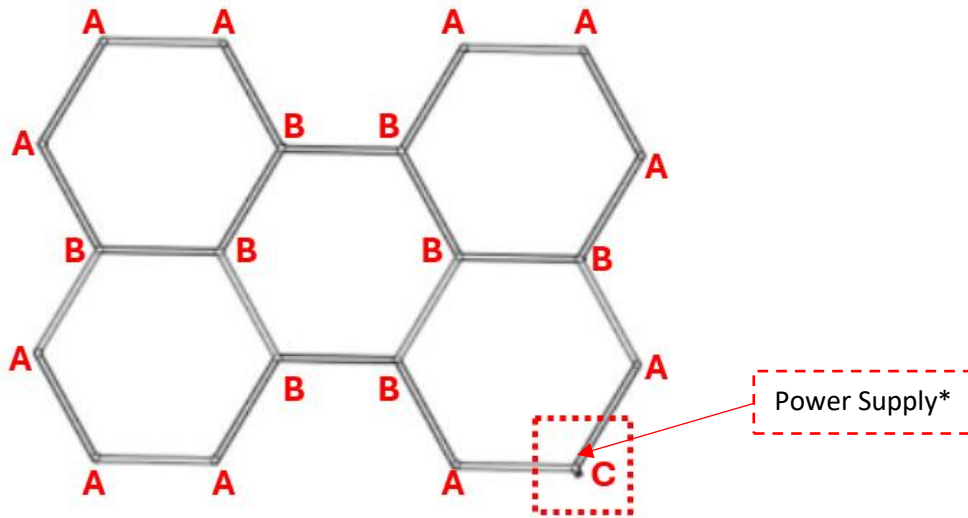

Figure C shows power supply.

**Power supply can be positioned at any outer connection point and not limited to placement shown in above diagram.*

IT IS ADVISED TO TEST THE OPERATION OF THE LIGHT TO ENSURE SECURE CONNECTIONS BEFORE PROCEEDING TO NEXT STEP AND MOUNTING THE FIXTURE.

MOUNTING INSTRUCTIONS

WARNING: Turn off power supply from main circuit breaker first!

Flush Mount Ceiling Installation (Cable Tie or Screws)

1. Turn off the electrical power.
2. Lift Hexagon Frame Fixture into place on ceiling where it will be installed.
 - a. It is advised that multiple people help lift fixture to ensure stability of the fixture.
3. Secure Hexagon Fixture to ceiling by one of two methods:
 - a. Use Cable Ties to secure fixture to grid ceiling ensuring the cable ties are mounted over the connecting points and not the light bars.
 - b. Use screws and anchors to install directly to ceiling surface by connecting screws through the keyholes in each connector.
4. Plug in each power cord to the closest outlet.
5. Turn on electrical power.



Installed with cable tie



Installed with screws.

Installation Method # 2: Suspended Mounting (mounting cables sold separately)

Requires SKU LEDHDWR10000055000 Mounting Accessory (sold separately)

1. Turn off the electrical power.
2. Review the below chart for recommended suspension points on the fixture. There are 20 recommended mounting points, but more mounting points can certainly be used with extra cables. Each connector in the design has a keyhole that can support a mounting cable.

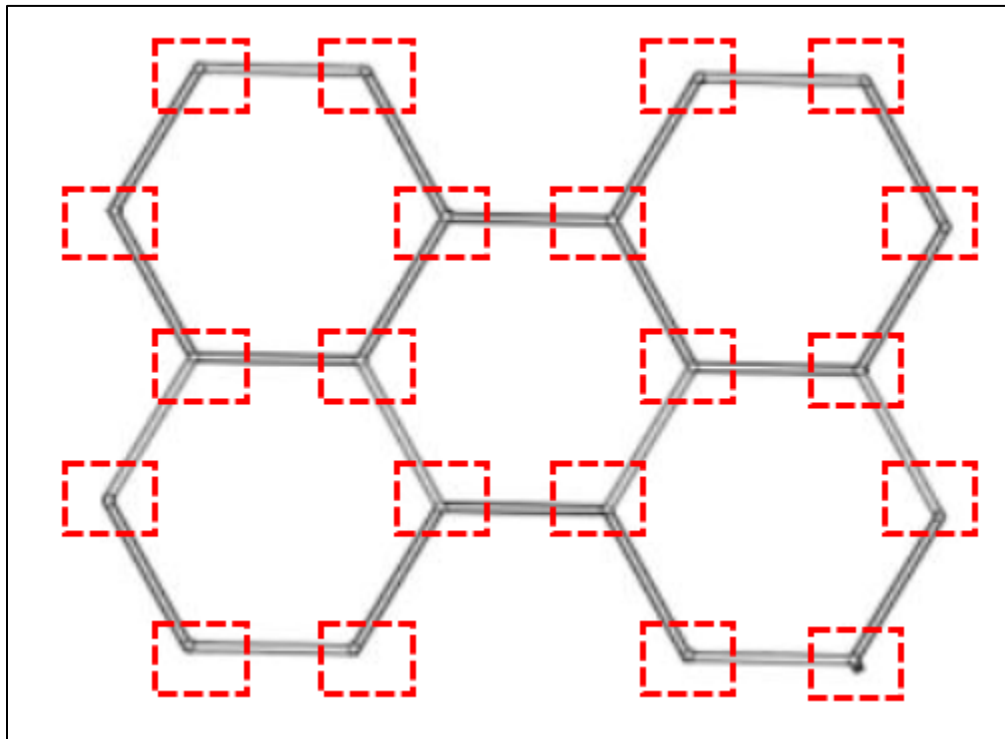

3. Layout the installation points on the ceiling where each mounting cable will be installed.
4. Install wall plug and then install a mounting stud for each suspension wire.
5. Feed the suspension cable through the keyhole on the connectors at the marked mounting points in the array.
6. Once all mounting points have the cables attached to the connectors, lift Hexagon Fixture into place in the air where it will be suspended.
 - a. It is advised that multiple people help lift fixture to ensure stability of the fixture.
7. Plug in each power cord to the closest outlet.
8. Turn on electrical power.

Below figure shows detail of attaching mounting cables to connectors and to the ceiling.

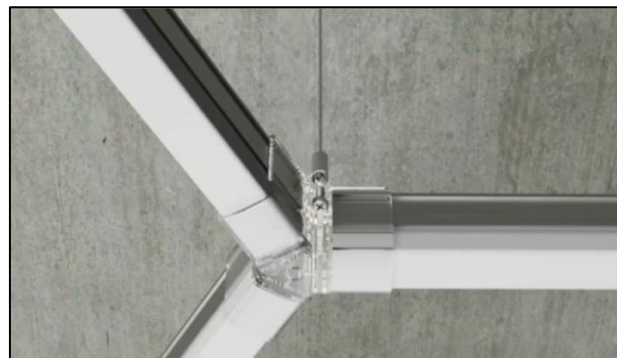
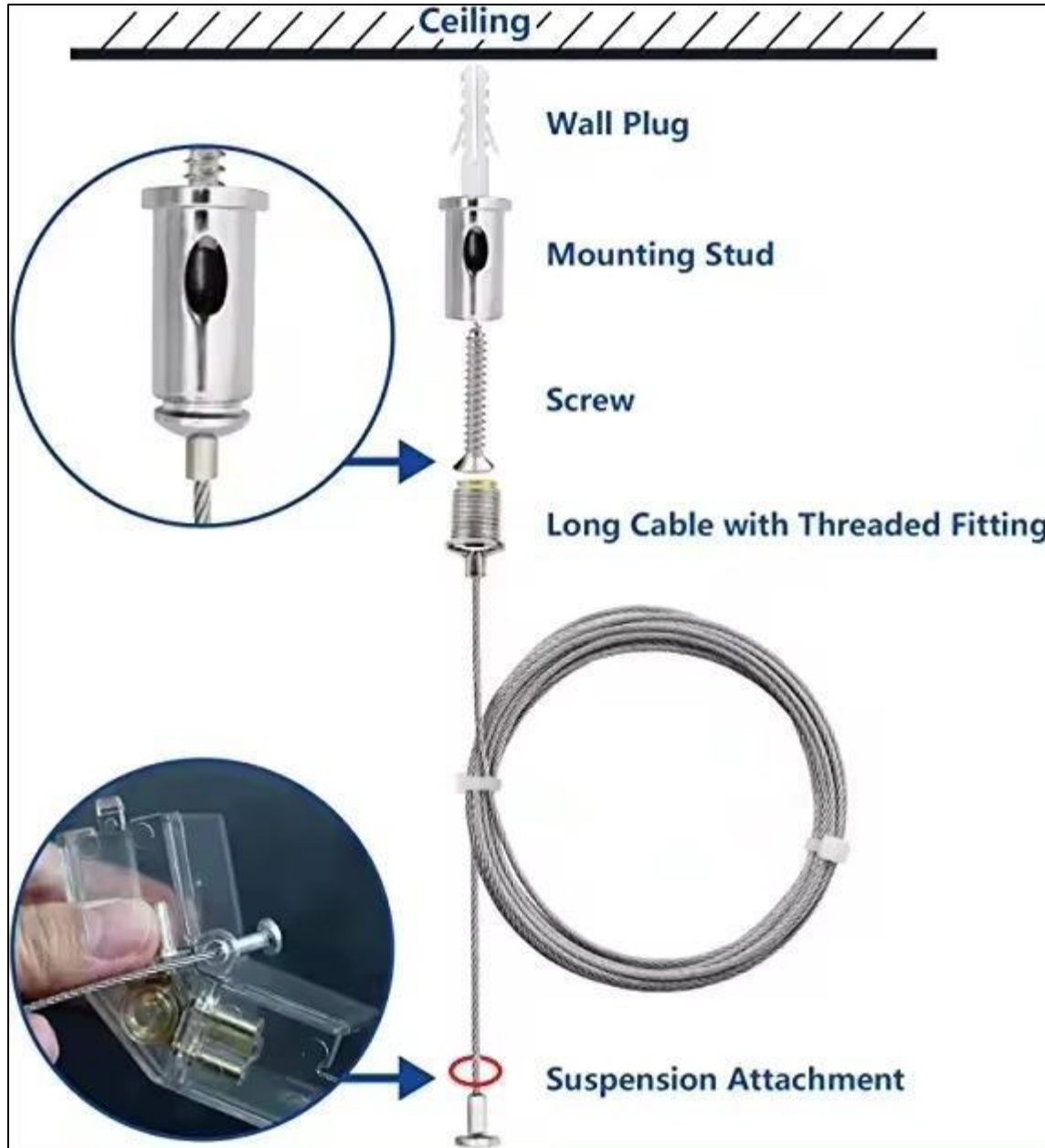

Installed with suspension cable

General Troubleshooting

Having trouble? Before contacting the manufacturer, please review below troubleshooting checklist:

- **Verify your power source is on.**
- **Check electrical connections for secure connections.**

FAQs

- **Can this product be used in an outdoor parking bay or car wash?**
 - **No, this product is dry rated for indoor use only.**
- **Is this product dimmable?**
 - **Yes, this product is dimmable. Dimmable with triac dimmer at 120V (dimmer sold separately).**

5-Year Limited Warranty

LumeGen (Seller) carries a limited warranty on all of its LED products for manufacturing defects and product failures. The warranty period for commercial products is 5 years from the date of purchase (based on 12 hours per day, 7 days per week of normal commercial use). If LumeGen LED products fail to operate within the warranty period listed above when used as directed, contact LumeGen Customer Service Department to initiate the return process and explain your warranty claim. Failure to follow the procedure as provided by the Customer Service Department will void this warranty.

What you Do: We ask that you call our Customer Service Department at 800-998-6977 to obtain an RMA number and explain the warranty issue. It is the customer's responsibility to pay for the return shipping of the defective product(s) back to the Seller. If the product(s) is found to be defective, the Seller will pay for the shipping costs of the replacement product(s) back to the customer. The returned product(s) must include the RMA # clearly marked on the outside of the packaging, and must include a copy of the original proof of purchase (invoice or sales order).

What we Do: Once we receive the product(s) in question, we will verify the defective claim on the product. If we determine that the defect was not caused by negligence, improper installation, electrical surges, alteration, abuse, unauthorized repair, or disassembly, we will send you a replacement LumeGen Product(s). If an identical replacement is not available for any reason, LumeGen reserves the right, at its sole discretion, to replace the defective product(s) with a different product(s) of equal value that most closely matches the specifications of the original product. Replacement of the defect product(s) is LumeGen's sole warranty obligation, and case or credit refunds will not be offered.

This Limited Warranty is subject to the following conditions:

- Seller is not responsible for incidental and consequential damages that may occur during the return of the product to the seller.
- This warranty is extended only to the original purchaser of the product from Seller. This warranty does not cover any third-party products or devices used in conjunction with the product purchased.
- Seller will not be responsible for any type of removal or re-installation costs, including labor and/or equipment charges or expenses, and will not be responsible for shipping costs or expenses to return the product(s) back to the Seller.
- This warranty covers products purchased in, and used within, the United States or Canada. No agent, distributor, or dealer is authorized to change, modify, or extend the terms of this Limited Warranty on behalf of LumeGen. For warranty or other questions, please call 800-988-6977 or email customerservice@onlinestores.com.